



5" SJS™ II High-Power Angle Grinder with Tuck Point Guard Model GA5042CX1

SJS™ II ANGLE GRINDER WITH 5" TUCK POINT GUARD AND DIAMOND BLADE

- Powerful 12.0 AMP Motor Delivers More Output and variable (2,800 - 11,000 RPM) for the most demanding applications
- SJS™ II provides a mechanical gear drive system to help prevent motor and gear damage by dampening the force on the gear when the wheel is forced to stop
- SJS™ II provides a leaf spring and cam gear drive mechanism that is engineered to reduce vibration for increased operator comfort during extended use
- Includes a 5" dust extraction tuck point guard for clean & accurate tuck pointing and cutting
- Electronic Controller provides constant speed control which automatically applies additional power to the motor to maintain speed under load

POWER

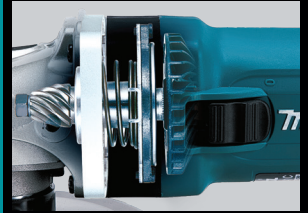

Powerful 12.0 AMP motor delivers more output and 2,800 - 11,000 RPM

DURABILITY

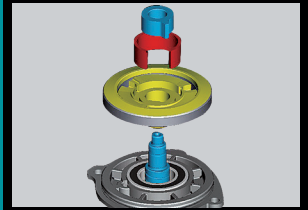

SJS™ II provides a mechanical gear drive system to help prevent motor and gear damage

COMFORT

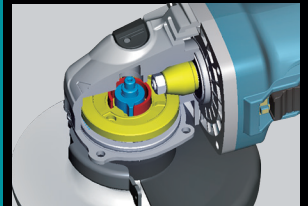

SJS™ II provides a leaf spring and cam gear drive mechanism that is engineered to reduce vibration

VERSATILITY



Fully featured tuck point guard for precision cutting and maximum dust extraction



LESS VIBRATION

5" SJS™ II High-Power Angle Grinder with Tuck Point Guard

Model GA5042CX1

FEATURES & BENEFITS

- Soft start suppresses start-up reaction for smooth start-ups and longer gear life
- Electronic current limiter helps protect the motor from overload
- Labyrinth construction seals and protects the motor and bearings from dust and debris for longer tool life
- "Tool-less" wheel guard for easy adjustment
- Vibration absorbing side handle provides increased comfort on the job
- 5" dust extraction tuck point guard includes:
 - Easily adjustable depth setting for quick changes
 - Adjustable depth stops for added user convenience
 - Clear viewing window for improved visibility
 - Plunge feature allows for improved dust containment

STANDARD EQUIPMENT

- 5" dust extracting tuck point guard (196845-3)
- 5" dual sandwich diamond tuck point blade (A-96017)
- Lock nut wrench (782412-6)
- Side handle (162258-0)
- Lock nut (224568-4)
- Inner Flange (224399-1)
- "Tool-less" wheel guard (123145-8)
- Tuck guard hex wrench (783222A4)

SPECIFICATIONS

	GA5042CX1
Grinding wheel/ sanding disk	5"
Wire cup brush	3-1/2"
No load speed (variable)	2,800 - 11,000 RPM
Spindle thread	5/8"-11 UNC
AMPS	12
Lock-On	Yes
Lock-Off	No
Overall length	11-7/8"
Net weight	5.4 lbs.
Shipping weight	7.4 lbs.
UPC code	088381-698788



Model GA5042CX1



OPTIONAL ACCESSORIES

- Segmented blade, general purpose (A-94699)
- Turbo rim blade, general purpose (A-94568)
- Crack chaser, general purpose (D-09606)
- Tuck point blade, general purpose (A-96017)



Makita offers a wide variety of accessories. For a complete listing, please refer to the Makita General Catalog or visit our website at makitatools.com, or call 1-800-4MAKITA.

All specifications subject to change without prior notice. All models and accessories subject to stock on hand.
The Makita Teal Color is the trade dress of Makita Corporation and is protected under common law and registered with the U.S. Patent and Trademark Office
NTF-0315.MA5059-15B