

STAIN ERASER PET

USER GUIDE
2006F

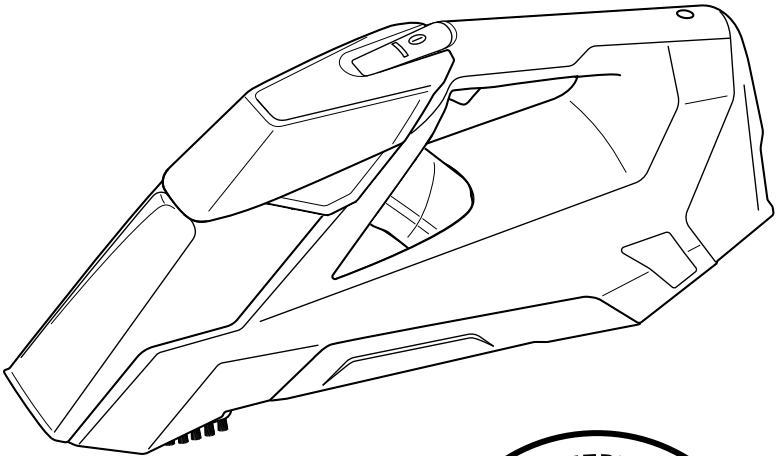

IMPORTANT SAFETY INSTRUCTIONS

READ ALL INSTRUCTIONS BEFORE USING YOUR APPLIANCE.

Unplug from outlet when not in use and before conducting maintenance. When using an electrical appliance, basic precautions should be observed, including the following:

WARNING

TO REDUCE THE RISK OF FIRE, ELECTRIC SHOCK, OR INJURY:



- » This appliance can be used by children aged from 8 years and above and persons with reduced physical, sensory or mental capabilities or lack of experience and knowledge if they have been given supervision or instruction concerning use of the appliance in a safe way and understand the hazards involved. Cleaning and user maintenance shall not be made by children without supervision.
- » Children should be supervised to ensure that they do not play with the appliance.
- » Keep hair, loose clothing, fingers, and all parts of body away from openings and moving parts of the appliance and its accessories.
- » Unplug from electrical socket when not in use, before cleaning, maintaining or servicing the appliance, and if your appliance has an accessory tool with a moving brush, before connecting or disconnecting the tool.
- » If the charger supply cable is damaged, it must be replaced by the manufacturer, its service agent, or similarly qualified person in order to avoid a hazard.
- » Plastic film can be dangerous. To avoid danger of suffocation, keep away from children.
- » Use only as described in this user guide.
- » Use only manufacturer's recommended attachments.
- » Do not immerse in water or liquid.
- » If appliance is not working as it should, has been dropped, damaged, left outdoors, or dropped into water; do not attempt to operate it and have it repaired at an authorized service center.
- » Do not put any object into openings.
- » Do not use with any opening blocked; keep free of dust, lint, hair, and anything that may reduce air flow.
- » Use extra care when cleaning on stairs.
- » Do not use to pick up flammable or combustible liquids, such as petroleum, or use in areas where they may be present.
- » Do not pick up toxic material (chlorine bleach, ammonia, drain cleaner, etc.)
- » Do not use appliance in an enclosed space filled with vapours given off by oil base paint, paint thinner, some mothproofing substances, flammable dust, or other explosive or toxic vapours.
- » Do not pick up hard or sharp objects such as glass, nails, screws, coins, etc.
- » Keep appliance on a level surface.
- » Do not pick up anything that is burning or smoking, such as cigarettes, matches, or hot ashes.
- » Do not pull or carry charger by cable, use cable as a handle, close door on cable, or pull cable around sharp edges or corners.
- » Keep charger cable away from heated surfaces.
- » To unplug, grasp the charger plug, not the cable.
- » Do not handle charger plug or appliance with wet hands.
- » Battery pack and charger base output terminals are not to be short-circuited.
- » Do not charge the unit outdoors. Do not use outdoors.
- » Do not incinerate the appliance even if it severely damaged. The batteries can explode in a fire.
- » The appliance must be disconnected from the supply mains when removing the battery.
- » The battery is to be disposed of safely.
- » Do not recharge, disassemble, heat above 60°C or incinerate.

- » Keep batteries out of reach of children.
- » Dispose of used batteries promptly.
- » Never put batteries in mouth. If swallowed, contact your physician or local poison control.
- » This appliance contains batteries that are only replaceable by skilled persons.
- » Ensure to use the appropriate charger by series. For all Australia models, reference charger series SSA-100060AU.
- » Prevent unintentional starting. Ensure the switch is in the off-position before picking up or carrying the appliance. Carrying the appliance with your finger on the switch or energizing appliance that have the switch on invites accidents.
- » Under abusive conditions, liquid may be ejected from the battery; avoid contact. If contact accidentally occurs, flush with water. If liquid contacts eyes, additionally seek medical help. Liquid ejected from the battery may cause irritation or burns.
- » Do not use appliance that is damaged or modified. Damaged or modified batteries may exhibit unpredictable behavior resulting in fire, explosion or risk of injury.
- » Do not expose appliance to fire or excessive temperature. Exposure to fire or temperature above 130°C may cause explosion.
- » Follow all charging instructions and do not charge the appliance outside of the temperature range specified in the instructions. Charging improperly or at temperatures outside of the specified range may damage the battery and increase the risk of fire.
- » Have servicing performed by a qualified repair person using only identical replacement parts. This will ensure that the safety of the product is maintained.
- » Do not modify or attempt to repair the appliance except as indicated in the instructions for use and care.
- » Keep the temperature range of between 4-40°C when charging battery, storing unit or during use.
- » Ensure to use the appropriate charger by series. For all UK models, reference charger series SSA-100060UK.
- » Recharge only with the charger specified by the manufacturer. A charger that is suitable for one type of battery pack may create a risk of fire when used with another battery pack.
- » Always connect to a properly earthed electrical socket. Do not modify earthed plug.
- » Liquid must not be directed towards equipment containing electrical components.
- » Use only on surfaces moistened by the cleaning process. Use only BISSELL cleaning products intended for use with this machine.
- » Use only the type and amount of liquids specified under the operations section of this guide.
- » Always install float before any wet pick-up operation.

SAVE THESE INSTRUCTIONS

FOR OPERATION ON A 220-240 VOLT A.C. 50-60 HZ POWER SUPPLY ONLY.

This model is for household use only.

	WARNING	RISK OF FIRE, ELECTRIC SHOCK, OR INJURY.
	GUIDE	READ USER GUIDE FOR COMPLETE SAFETY AND USER INSTRUCTIONS.
	WEEE	DO NOT THROW THE APPLIANCE AWAY WITH THE NORMAL HOUSEHOLD WASTE AT THE END OF ITS LIFE, BUT HAND IT IN AT AN OFFICIAL COLLECTION POINT FOR RECYCLING. BY DOING THIS YOU WILL HELP TO PRESERVE THE ENVIRONMENT.

Thanks for buying a BISSELL® Cordless Carpet & Upholstery Washer!

We love to clean and we're excited to share one of our innovative products with you. We want to make sure your portable deep cleaner works as well in two years as it does today, so this guide has tips on using (pages 6-9), maintaining (pages 10-13), and if there is a problem, troubleshooting (page 14).

In just a few simple assembly steps, you'll be ready to spot clean. Flip to page 6 and let's get started!

What's In The Box?

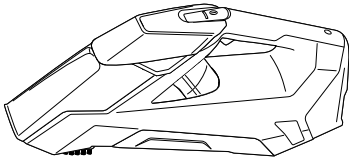

Stain Eraser Pet

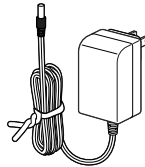

Charger Plug/Cord

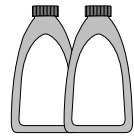

(2) BISSELL Trial Size Formulas



Straight Bristle Brush



Round Bristle Brush

Safety Instructions.....	2	Maintenance & Care	10-13
Product View.....	4	Troubleshooting	14
Cleaning Formula.....	5	Guarantee.....	16
Operations	6-9	Consumer Care.....	16

Product View

1. Formula and Clean Water Tank
2. Removable Nozzle
3. Scrubbing Brush
4. Tank Release Latch
5. Dirty Water Tank
6. Battery Charging Port
7. Spray Trigger
8. Power Switch
9. Battery Status Indicator Lights
10. Charger Plug/Cord

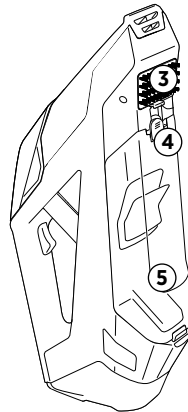
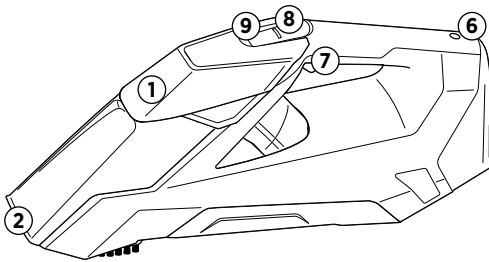
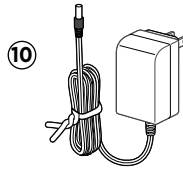

Cleaning Formula



BISSELL
Boost OXY



BISSELL 2X Pet
Stain & Odour



BISSELL
Spot & Stain

Keep plenty of genuine BISSELL Spot & Stain Cleaning formula for portable spot cleaning machines on hand so you can clean whenever it fits your schedule. Always use genuine BISSELL cleaning formulas.

NOTICE: Use of cleaning formulas which contain lemon, pine or eucalyptus oil may damage this appliance and void the guarantee. Chemical spot cleaners or solvent-based soil removers also should not be used. These products may react with the plastic materials used in your cleaner, causing cracking or pitting.

Charging the Battery

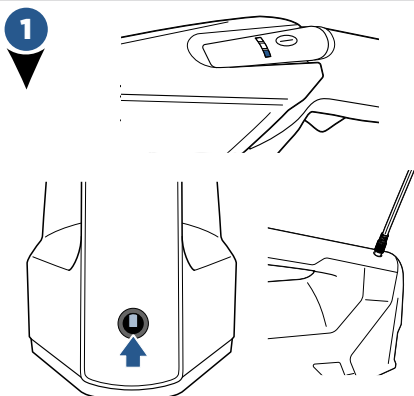

Before charging, make sure unit is off by ensuring the battery status indicator lights are not illuminated. Insert the charging adapter plug into the charging port on the handle near the base of the unit.

NOTE: There is a door covering the charging port that will automatically slide out of the way when the charging adapter is inserted.

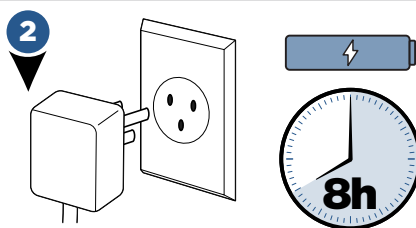

Plug the adapter into a suitable wall outlet. The battery status indicator lights will illuminate when charging.

For maximum run time, charge the unit 8 hours prior to use. Refer to the chart below for understanding the charging status.

NOTE: On first use, make sure your unit is fully charged before using it. To check the battery status, turn the machine ON by pressing the power button on the handle. Battery is fully charged when all three of the blue status lights are illuminated. See chart below.

IMPORTANT: Before storing unit, ensure dirty water tank is empty. Unit should not be left on its side with water in the dirty water tank.

Charging Light Display Status



BATTERY STATUS	LIGHT STATUS
100%	
99% to 66%	
65% to 33%	
32% to 1%	
0%	

NOTE: Keep the temperature range of between 0-40°C (32-104°F) when charging battery, storing unit or during use.

NOTE: Use only with charger SIL, Model SSA-100060AU.

Filling the Solution Tank

1

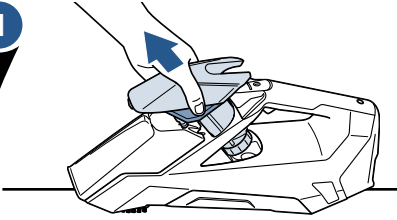

Pull the tank away at an angle to remove it from the unit.

2

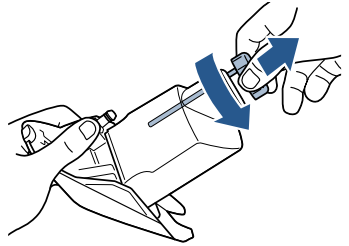

Twist and remove the tank cap.

3



Use hand-warm tap water to fill to the water line indicated on the solution tank.

4

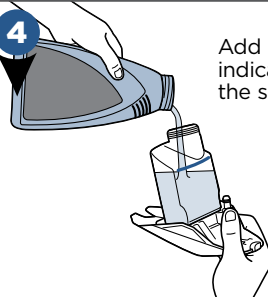

Add formula to the indicated fill line on the solution tank.

5

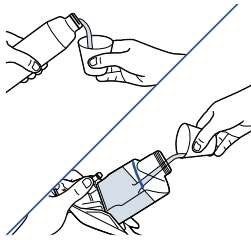

If desired, add 14.7mL of Oxy Boost Formula.

6

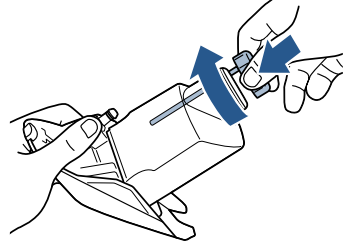

Twist to replace the cap on the tank.

7

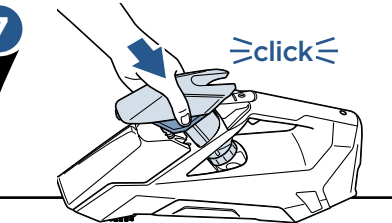

Return the tank to the unit making sure it is fully seated.

8

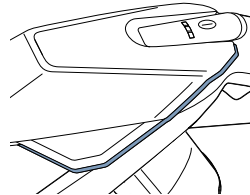

To ensure the tank is fully seated, make sure there are not gaps in the seams between the tank and unit.

Pre-Treating

IMPORTANT: Check the manufacturer's tag before cleaning upholstery. If manufacturer's tag is missing or not coded, check with your furniture dealer.

1

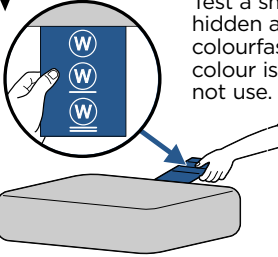

Check manufacturer's tag before cleaning. Test a small, hidden area for colourfastness. If colour is affected, do not use.

2

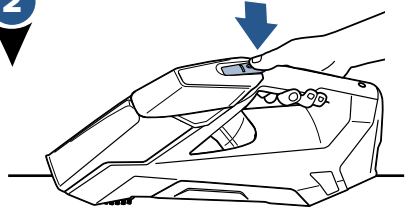

Push power button to turn the unit ON.

3

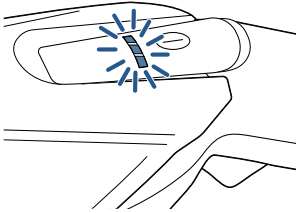

Battery status lights will illuminate to show how much battery remains.

4

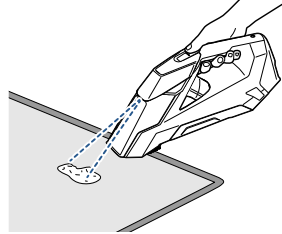

To pretreat stained or soiled areas, hold the unit above soiled surface and press spray trigger until the entire area is wet.

5



Let cleaning solution set for 5 minutes before cleaning.

Spot Cleaning Carpet & Upholstery

WARNING

Keep spray away from face. Failure to do so may result in personal injury.

NOTE: If unit stops spraying, push power button to turn unit off and check cleaning solution level. Refill if needed. Never run dry.

NOTE: When cleaning upholstery, be sure to use the unit vertically upward.

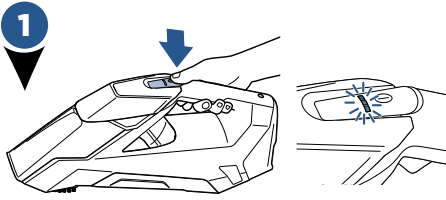

1 Push power button to turn the unit ON. Battery status lights will illuminate to show how much battery remains.

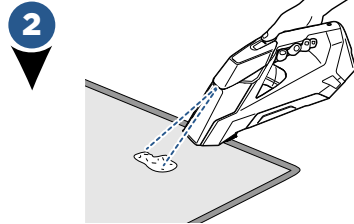

2 Hold the unit above soiled surface and press the trigger to spray cleaning solution.

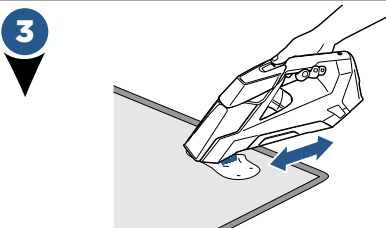

3 For stubborn spots, use brush to gently scrub soiled area while continuing to spray cleaning solution.

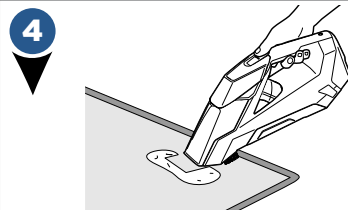

4 Press front of unit firmly against surface and pull toward you to remove cleaning solution. Be sure to release the trigger for optimal suction.

5 Repeat steps 2 and 4 until no more dirt or cleaning solution can be removed. Do not overwet.

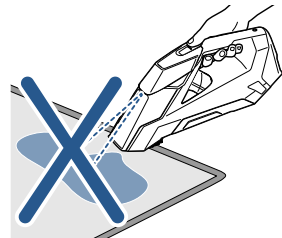
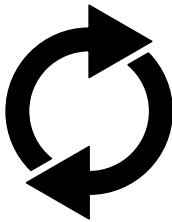

Empty Dirty Water Tank

WARNING

To reduce the risk of fire, electric shock or injury, turn power OFF and disconnect from charger before performing maintenance or troubleshooting.

1

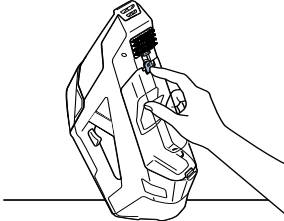

Ensure the unit is OFF and set upright on a flat surface. Simply push up on the release button located on the top of the tank to remove.

2

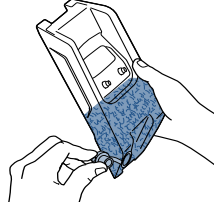

Carefully remove the dirty water tank from the unit and carry to a sink. To prevent spills, hold tank vertically after removing. To empty, pull tab at the end of the tank and empty to remove the dirty water.

3

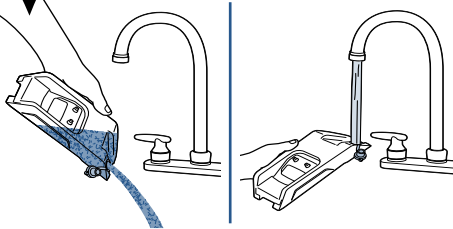

Rinse out the dirty tank with clean water after emptying.

4

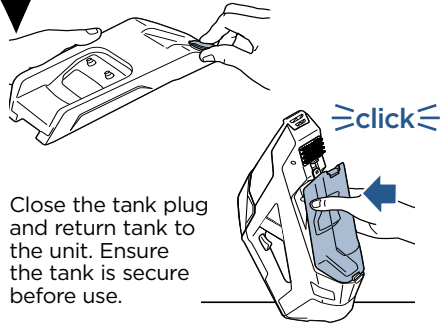

Close the tank plug and return tank to the unit. Ensure the tank is secure before use.

NOTICE: To reduce the risk of a leaking condition, do not store where freezing may occur. Damage to internal components may result.

Clean the Nozzle

WARNING

To reduce the risk of fire, electric shock or injury, turn power OFF and disconnect from charger before performing maintenance or troubleshooting.

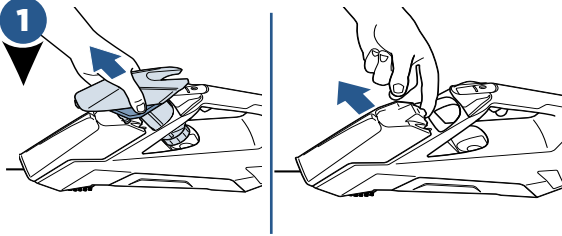

The front nozzle of the unit removes for easy cleaning of dirt and debris. Remove the clean water tank and locate the latch at the top of the nozzle. Pull tab and rotate back to separate from unit.

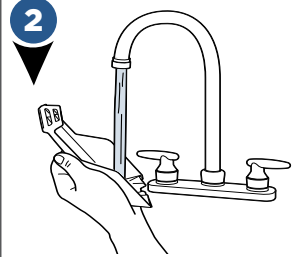

Rinse nozzle with clean water and check spray nozzle for dirt or debris.

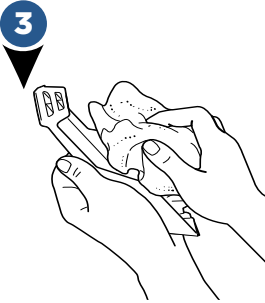

If necessary, wipe with a clean cloth or soft bristle brush.

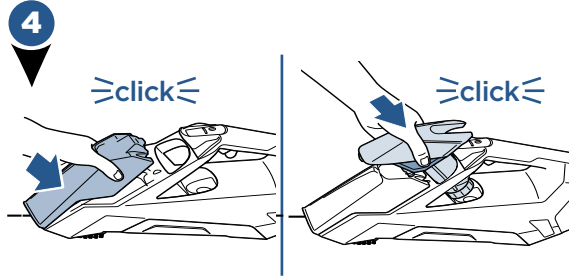

Replace the front nozzle by hooking lower edge onto unit and snapping into place. Then place the clean tank back on the unit.

Clean the Brush

WARNING

To reduce the risk of fire, electric shock or injury, turn power OFF and disconnect from charger before performing maintenance or troubleshooting.

1

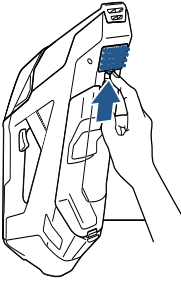

Ensure the unit is OFF and set upright on a countertop or flat surface. Remove the scrubbing brush by lifting the tab up and pulling gently to release.

2

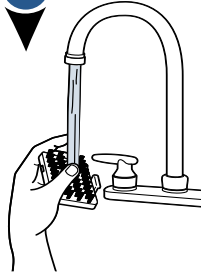

Rinse brush with clean water and check brush for debris. Once cleaned, insert brush by aligning the top of the brush into the unit and snap into place. Ensure it is secure before using.

Disposal of Batteries

WARNING

This product contains Lithium Ion rechargeable batteries. Proper removal and disposal of batteries is required.

NOTICE: Disconnecting the battery will destroy the appliance and invalidate the guarantee.

Before proceeding, ensure that:

- the unit is disconnected from the charger
- the clean water tank, collection tank, nozzle and brush have been removed from unit (see removal instructions)
- you have a flat head and Phillips screwdriver, required for disassembly

1

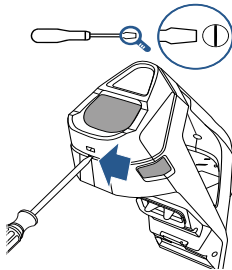

Remove the cover on the base of the unit by using a flat head screw driver.

2

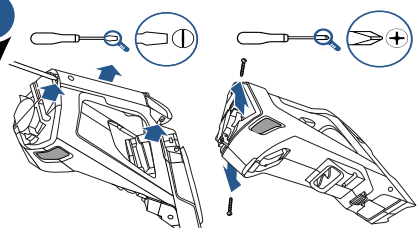

Remove the screw near the LED window using a Phillips screwdriver. Then, remove entire top handle portion from unit by using a flat head screwdriver.

Disposal of Batteries (cont'd)

3

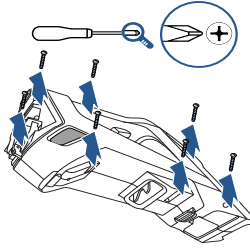

Using a Phillips screwdriver, remove seven screws in the locations referenced in the image.

4

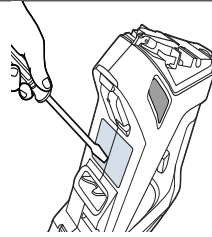

Remove product rating label. Pull open the housing on the base of the unit in opposite directions. Disconnect and remove the entire battery assembly.

5

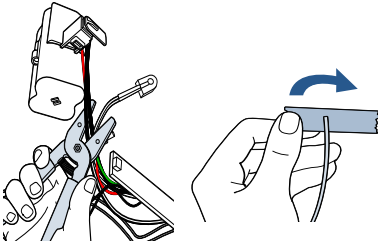

Cut the two black wires and secure each wire end with tape.

6

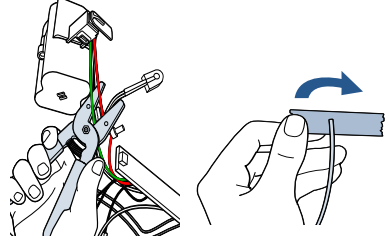

Cut the red and green wires and secure each wire end with tape.

7

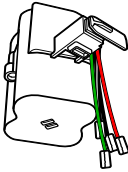

Be sure all wire ends are taped before disposing.

8

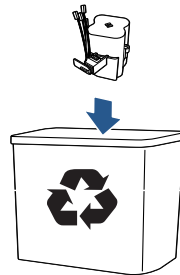

Recycle full battery pack.

NOTE: Keep Battery Pack together – DO NOT separate individual batteries. For specific disposal instructions, please follow local regulations.

Troubleshooting

WARNING

To reduce the risk of electric shock, turn power switch off and disconnect from charger before performing maintenance or troubleshooting checks.

Problem	Possible causes	Remedies
Reduced suction or no suction	Dirty water tank is full	Empty dirty water tank
	Dirty water tank drain plug is loose	Check plug for snug fit
	Batteries weak/undercharged	Recharge according to instructions
	Dirty water tank not properly installed	Snap tank into place
Reduced or no suction on the window tool (select models)	Nozzle improperly installed	Remove and reinstall nozzle
	Squeegee is tilted away from the window	Ensure the squeegee is against the window for optimal suction
	Improperly attached window tool	Remove and reinstall window tool
Reduced spray or no spray	Solution/clean tank is empty	Refill solution/clean tank
	Pump not primed	While the unit is turned on, press spray trigger and gently rock Pet Stain Eraser back and forth
	Batteries weak/undercharged	Recharge according to instructions
	Spray tip clogged	Rinse tip with clean water
	Clean tank not fully inserted	Ensure clean tank is securely seated by removing and then replacing
Unit is not powered or underpowered	Charger plug/cord not connected	Make sure charger plug is completely plugged into wall outlet and charging cord is completely plugged into port on back of unit
Unit will not charge	Charger plug/cord not connected	Make sure charger plug is completely plugged into wall outlet and charging cord is completely plugged into port on back of unit
	Not the correct charger	Use only the charger that comes with the machine
Unit is leaking	Formula tank is not properly seated	Ensure formula tank is fully seated, see page 7
	Dirty tank plug is not sealed properly	Ensure dirty tank plug is sealed properly, see page 10
	Dirty tank is full	Empty dirty tank. Unit should not be left on its side with water in the dirty tank, see page 10
	Unit is not level	Ensure unit is upright

Notes

Consumer Guarantee

This Guarantee gives you specific legal rights, in addition to rights you may have under the Australian consumer law. If you need additional instruction regarding this Guarantee or have questions regarding what it may cover, please contact your local BISSELL Consumer Services on the details set out below.

Limited 2 Year Guarantee (from the date of purchase by original purchaser)

Subject to the *CONDITIONS identified below, BISSELL will repair or replace (with new, refurbished, lightly used, or remanufactured components or products), at BISSELL's option, free of charge, any defective or malfunctioning part due to manufacturer defect. This Guarantee applies to product used for personal purposes, and not commercial or rental service. This Guarantee does not apply to fans or routine maintenance or consumable components such as filters, belts, brush rolls, etc., damage or malfunction caused by negligence, abuse, neglect, unauthorized repair, or any other use not in accordance with the user's guide. BISSELL recommends that the original packaging be kept for the duration of the Guarantee period in case such need arises within the Guarantee period that the item needs re-packing and transportation.

*CONDITIONS OF THE GUARANTEE

Subject to whether such loss is reasonably foreseeable, BISSELL and its in-country distributors are not liable for incidental or consequential damages of any nature associated with the use of this product.

FOR AUSTRALIAN CONSUMERS ONLY:

OUR GOODS COME WITH GUARANTEES THAT CANNOT BE EXCLUDED UNDER THE AUSTRALIAN CONSUMER LAW. YOU ARE ENTITLED TO A REPLACEMENT OR REFUND FOR A MAJOR FAILURE AND FOR COMPENSATION FOR ANY OTHER REASONABLY FORESEEABLE LOSS OR DAMAGE. YOU ARE ALSO ENTITLED TO HAVE THE GOODS REPAIRED OR REPLACED IF THE GOODS FAIL TO BE OF ACCEPTABLE QUALITY AND THE FAILURE DOES NOT AMOUNT TO A MAJOR FAILURE.

THIS GUARANTEE IS IN ADDITION TO OTHER RIGHTS OR REMEDIES UNDER LAW. NOTHING IN THIS GUARANTEE EXCLUDES, LIMITS OR MODIFIES ANY LIABILITY OF BISSELL WHICH IS IMPOSED BY LAW, OR LIMITS OR MODIFIES ANY REMEDY AVAILABLE TO THE CONSUMER WHICH IS GRANTED BY LAW. TO MAKE A CLAIM UNDER THIS GUARANTEE CONTACT BISSELL AUSTRALIA PTY LTD (DETAILS ABOVE). CONTACT BISSELL PRIOR TO RETURNING ANY GOODS. WHERE AGREED, BISSELL WILL REIMBURSE REASONABLE POSTAGE / HANDLING COSTS (IF ANY) FOR RETURNING GOODS TO BISSELL. TO CLAIM EXPENSES INCURRED IN MAKING A CLAIM UNDER THIS GUARANTEE PLEASE PROVIDE BISSELL WITH A COPY OF THE RECEIPT OF THE EXPENSES BY EMAIL OR POST.

Consumer Care

If your BISSELL product should require service or to claim under our limited guarantee, please contact us as follows:

Website and Email:

www.bissell.com.au
www.bissell.co.nz

Telephone:

Australia: 1300-247-735
New Zealand: 0800-247-735

Write:

BISSELL AUSTRALIA PTY LIMITED
42 Rocco Dr.
Scoresby 3179
Victoria
Australia

Replacement parts and accessories are available for purchase. To purchase visit www.BISSELL.com.au.

Visit the BISSELL website: www.BISSELL.com.au

When contacting BISSELL, have model number of cleaner available.

Please record your Model Number: _____ Please record your Purchase Date: _____

NOTE: Please keep your original sales receipt. It provides proof of the date of purchase in the event of a Guarantee claim. See Guarantee for details.



©2018 BISSELL Homecare, Inc
Grand Rapids, Michigan
All rights reserved. Printed in China
Part Number 161-4736 02/18 RevA
Visit our website at: www.BISSELL.com.au