

JARDAN

Goldie

Assembly Instructions

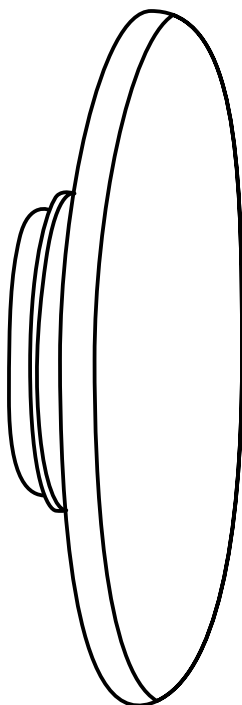

Goldie Wall Light



jardan.com.au

JARDAN

Goldie Assembly Instructions

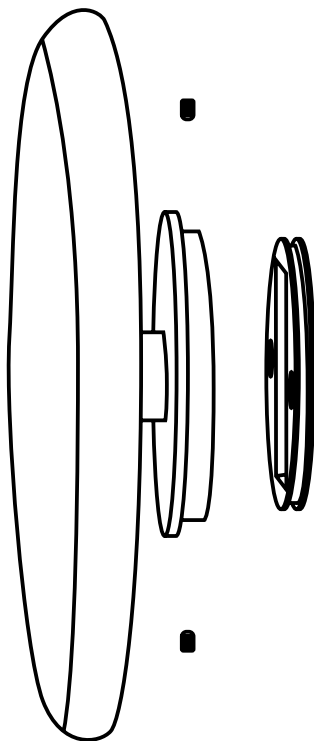

Components

1 x Goldie Sconce
1 x Wall Bracket
1 x LED Driver

Required

1 x Allen Key Size 3
1 x Drill + Drill bits
2 x Screws + Substrate fixings

JARDAN

Goldie Assembly Instructions

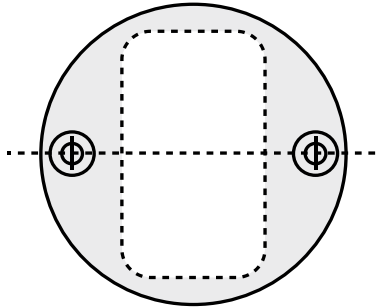

Using the Wall Bracket, mark out the location and level on the wall. Mark out the fixing points and central cavity by drawing around the inside of the rectangle.

- 1** Use suitable substrate fixings for the screw terminals at the marked locations. Drill or cut out the central cavity on the wall taking care not to interfere with the fixing points.
-

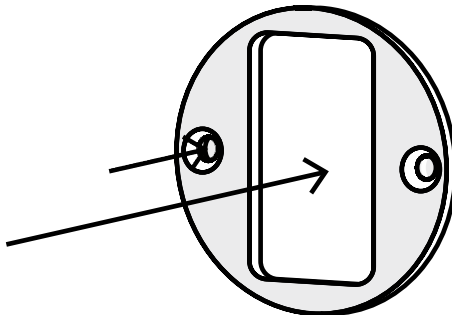

Offer the Wall Bracket up to the wall and fix both points using appropriate screws into the substrate fixings.

- 2** Ensuring power is off, create the electrical connections and feed the driver through the opening into the wall cavity. Feed the Red cable to the Positive (+) on the driver while the black cable connects to the Negative (-).
-

JARDAN

Goldie Assembly Instructions

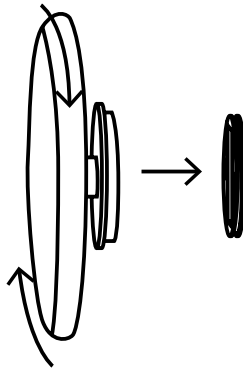

Wearing gloves so as not to mark the surface, position the Goldie Wall Plate over the bracket with the grub screws at the top and bottom.

3

The orientation can be rotated if required before the grub screws are tightened.



Using the Allen key, tighten both grub screws thoroughly ensuring they are secured into the groove in the Wall Bracket. The luminaire is now ready for use.

4

*If using the Casambi Bluetooth system, please refer to the Casambi website for set-up instructions: <https://support.casambi.com/support/home>

JARDAN

This installation guide will help your electrician simply and safely install your Goldie Wall Light. Jordan carries out a test assembly prior to delivery, but please ensure that all necessary components are present and use this handbook as a reference throughout the installation process.



WARNING

This installation must only be done by a licensed electrician. Due to the nature of the bronze finish, Goldie will patina and age over time. Always wear gloves when handling to avoid marking, Jordan does not take responsibility for any marking during installation. Wipe with a dry micro-fibre cloth only, do not use water or cleaning products.

Warranty and Care

- Made to last, our lighting is covered by a 1 year structural warranty.
 - Wipe with a dry micro-fibre cloth only, ensuring light is turned off before proceeding.
-

Contact

For more information visit our website. If you can't find what you're looking for our friendly sales team will be happy to help, contact your nearest Jordan store.

jordan.com.au
